

Product Installation Guidelines & Scope of Use

Version 1.3, 24 September 2025, Page 1 of 5  
Document No.: 001.00.50.04

# GalvinCare® CP-BS Lead Safe™ MH Ligature Resistant Basin Set Complete With High Flow Spout

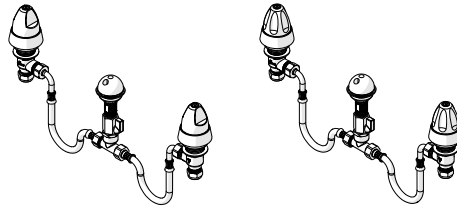

PRODUCTS	
Item Code	Description
121.63.23.03	GalvinCare® CP-BS Lead Safe™ MH Ligature Resistant Ezy-Grip Basin Set with High Flow Spout
121.64.23.03	GalvinCare® CP-BS Lead Safe™ MH Ligature Resistant Multi-Grip Basin Set with High Flow Spout

## SPECIFICATIONS

- Designed for maximum protection against vandalism, GalvinCare® basin/sink assemblies are made from heavy duty components
- The basin/sink assembly is made of chrome plated brass.
- Quarter turn ceramic disc.
- Machined cold or hot identification button.
- Ligature Resistant design.
- Available with either Ezy-Grip or Multi-Grip handle (as shown above).
- Lead Safe™ brass construction.\*

**IMPORTANT:** All GalvinCare® taps are tested in accordance with AS 3718 and leave our premises in good working order.

\*Our Lead Safe™ product range is compliant with the Lead Free Requirements of the NCC 2022 Vol. Three, Clause A5G4(2) and NSF/ANSI 372.

\*\*Any flow controller incorporated in the outlet to be tightened to prevent removal by hand. As Per AS3718.

**WARNINGS:** Special attentions to be paid on notes, photos, images, or drawings of assembly steps marked with the warning symbol.



## TECHNICAL DATA

Inlet	1/2" CU/ G 1/2"	
Outlet	Domed	
Headwork	Ceramic	
Working Pressure Range (kPa)	Min	50
	Max	500
Maximum Working Temperature (°C)	Min	5
	Max	65
Nominal Flow Rate (LPM)	5.89	
Finish	Chrome	

**NOTE:** Galvin Engineering continually strives to improve their products. Specifications may change without prior notice.

## PRE-INSTALLATION

### MOUNTING DETAILS

- If the mounting holes do not already exist, mark out and drill the holes in the bench/trough, as shown in rough-in dimensions.

**Note:** Supplied flexi hoses are 225mm long. Maximum distance between outlet and body adjustment is 140mm

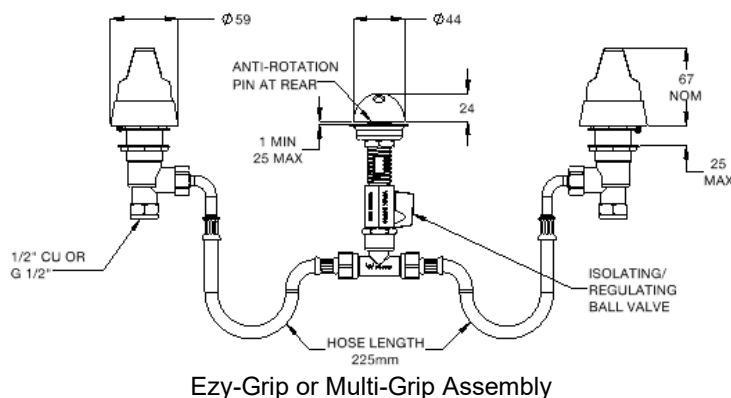
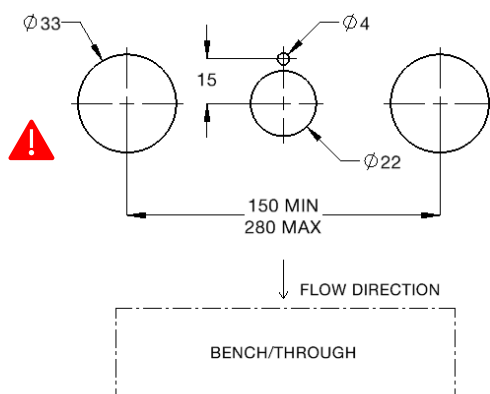

### TOOLS REQUIRED

- Power drill
- Spanner or adjustable crescent
- Thread tape/sealant

## INSTALLATION

**INSTALLATION COMPLIANCE:** Galvin Engineering products must be installed in accordance with these installation instructions and in accordance with AS/NZS 3500, the PCA and your local regulatory requirements. Water and/or electrical supply conditions must also comply to the applicable national and/or state standards. Failing to comply with these provisions shall void the product warranty and may affect the performance of the product.

**IMPORTANT:** Whilst our product designs take into account a broad range of installation types and surfaces, it is important that surfaces which fixtures are mounted to are flat and free from defect. This is especially important when installing product ranges that have been designed for correctional and health facilities, where special attention is required to minimise ligature points and areas for concealment of contraband. In addition to ensuring the products are fitted securely and in accordance with the following instructions, consideration shall be given to the use of non-pick mastics such as BASF Sonolastic "Ultra" to ensure a high quality and safe installation.

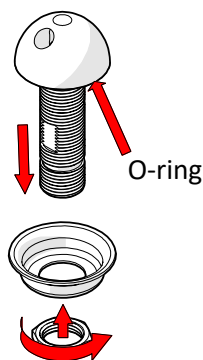

#### 1. Fit basin outlet

- Fit the basin outlet into the bench.
- Ensure the sealing o-ring is placed underneath the outlet and the anti-rotation pin locates properly
- Secure underneath with the supplied cup washer and back nut.

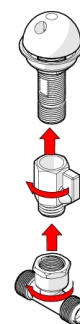

#### 2. Fit isolation regulating valve and t-piece

- Fit isolation valve to the outlet
- Fit supplied t-piece to the isolation valve
- Apply thread sealant or thread tape for sealing. Take care not to over tighten.

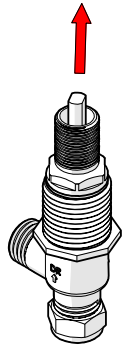

### 3. Fit basin bodies

- Insert basin body assemblies up through the pre-cut holes.

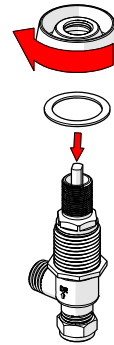

### 4. Fit dress flanges

- Fit washer onto dress flange and tighten.
- Screw bottom nut up and tighten.
- Tighten nuts holding the breach piece.

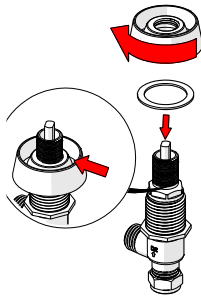

### 5. Fit dress flange with anti-rotation pin

- If the anti-rotation option is required, fit dress flanges onto body and mark the basin/sink, remove the flange and drill 3/16" hole
- Replace the flanges and screw in grub screws to lock.

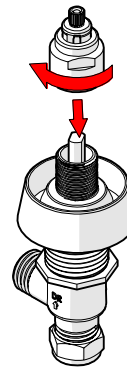

### 6. Fit lock sleeves

- Fit lock sleeves and tighten to lock entire unit in position.
- Take care not to over tighten.

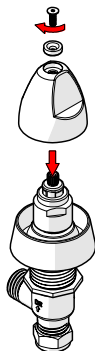

### 7. Assemble handles

- Fit handles with tamper proof screws, ensure the correct water temperature identification buttons are on the handle
- Screws must be tightened before the unit is tested

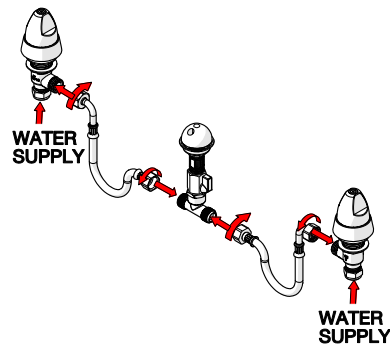

### 8. Fit flexi hose

- Fit flexi hoses to the basin taps and t-piece.
- Connect water supply to basin body inlet.

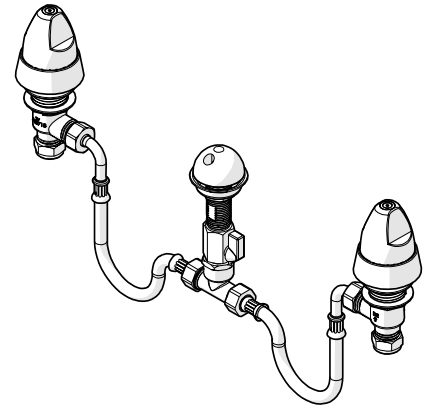

### 9. Testing

- Turn the handles and ensure that there is flow from outlet.
- Inspect the tap and check for any leaks.
- Adjust flow with isolation valve to achieve required flow

## TROUBLESHOOTING

PROBLEM	CAUSE	RECTIFICATION
Inconsistent flow	Blocked flow restrictor	Remove isolation valve, remove flow restrictor & clean with water
	Dirt in the top assembly cartridge	Remove cartridge, clean with water and re-grease spindle if required.
Continuous flow	Top assembly cartridge loose or internally obstructed or damaged.	Remove cartridge, clean with water and re-grease spindle if required.
Water is not flowing from tap	Water supply not on	Turn water on
Taps are dripping water	Ceramic cartridge is worn or damaged	Remove and inspect the cartridge, remove debris and /or replace cartridge if damaged
	Tap seat is damaged	Refurbish tap seat using a reseating tool

## WARRANTY

Galvin Engineering products are covered under our Manufacturer's Warranty. Galvin Engineering products must be installed in accordance with the installation instructions and in accordance with AS/NZS 3500 and NCC Volume Three, relevant Australian Standards and local authorities applicable to product being installed. Water and electrical supply conditions must also comply to the applicable national and/or state standards, failing to comply with these provisions may void the product warranty and affect performance of the product.

Please visit [www.galvinengineering.com.au](http://www.galvinengineering.com.au) to view the full warranty, our Installation Compliance and Maintenance & Cleaning information as well as any other additional information.

## DEFINITIONS AND DISCLAIMER

Galvin Engineering manufactures a range of products marked as Ligature Resistant or Vandal Resistant. Please visit [www.galvinengineering.com.au](http://www.galvinengineering.com.au) to read the definition of these terms and the disclaimer that applies to these products.

Within Australia: **1300 514 074** Outside Australia: P: +61 (0)8 9338 2344

F: +61 (0)8 9338 2340

[sales@galvinengineering.com.au](mailto:sales@galvinengineering.com.au)

[www.galvinengineering.com.au](http://www.galvinengineering.com.au)

ABN: 78 008 719 382

PERTH | SYDNEY | MELBOURNE | BRISBANE | ADELAIDE

